

# Actuator

14-  
557.02502

Distribution by  
DigiKey

**DigiKey**



<https://digikey.eao.com/p/14-557.02502>

Your product:

---



## 14-557.02502

### Actuator

#### FRONT

Front bezel colour:	Nature
Front bezel material:	Aluminium

#### OPERATING-/INDICATION PART

Lever material:	plastic
Lever colour:	Black
Lever shape:	long

#### ELECTRICAL CHARACTERISTICS

Rated Operational Voltage Ue:	250 VAC/DC according to EN IEC 61058-1
Electric strength:	3000 VAC, 50 Hz, 1 min. between all terminals and earth, according to EN/IEC 61058-1
Thermal current Ith:	5 A, according to EN / IEC 60947-5-1 The maximum current in continuous operation and at ambient temperature not exceeding the quoted maximum values.
Protection class:	II
Contacts:	2 NC / 2 NO
Switching voltage and switching current:	250 VAC, 5 A (ohmic) 250 VAC, 2 A (inductive, $\cos(\phi) = 0.7$ ) 220 VDC, 0.1 A (inductive, L:R = 30 ms) 110 VDC, 0.2 A (inductive, L:R = 30 ms) 60 VDC, 0.7 A (inductive, L:R = 30 ms) 24 VDC, 2 A (inductive, L:R = 30 ms)
Standards:	According to EN/IEC 61058-1
Electrical lifetime:	50 000 cycles of operation

#### MECHANICAL CHARACTERISTIC

<b>Switching angle:</b>	90° right
<b>Switching positions:</b>	2 positions
<b>Switching system:</b>	Snap-action switching element
<b>Contact material:</b>	Gold
<b>Switching action:</b>	Rest - Maintained
<b>Operating force:</b>	3 N ... 6 N, depending on the number of switching elements
<b>Terminal:</b>	Soldering terminal
<b>Operating Travel:</b>	ca. 90°
<b>Switching system:</b>	Self-cleaning, double-break snap action switching system, 1 normally closed and 1 normally open contact per element.
<b>Mechanical lifetime:</b>	1 Mio. cycles of operation
<b>Tightening torque:</b>	Fixing nut max. 0.25 Nm
<b>Weight:</b>	0.026 kg

## AMBIENT CONDITION

<b>Operating temperature:</b>	– 25 °C ... + 55 °C, mounted as a block, make sure the heat can escape freely
<b>Shock resistance:</b>	Max. 150 m / s <sup>2</sup> , pulse width 11 ms, 3-axis, (semi-sinusoidal as per EN IEC 60068-2-27)
<b>Vibration resistance:</b>	Max. 100 m / s <sup>2</sup> from 10 Hz ... 500 Hz, (sinusoidal EN IEC 60068-2-6)
<b>IP front protection:</b>	IP67, according to DIN EN 60529
<b>Storage temperature:</b>	– 40 °C ... + 85 °C
<b>Climate resistance:</b>	Standard condition, as per DIN EN 60068-2-78 Standard cyclic, as per DIN IEC 60068-2-30

## CERTIFICATE

<b>Conformities:</b>	CE, UKCA, 2011 / 65 / EC (RoHS), 2014 / 35 / EU (LVD)
<b>Approbations:</b>	CB (IEC 61058-1), CQC, CSA, DNV, ENEC (EN 61058-1), UL

## OTHER

<b>max. number of switching elements:</b>	2
<b>Short Description:</b>	Actuator, non illuminative, Black, long, Nature, Aluminium, anodised, 2 NC / 2 NO, Rest - Maintained, Soldering terminal, IP67, according to DIN EN 60529
<b>Hints:</b>	The colour of anodised aluminium parts can vary due to technical production reasons

### Dimension drawings:

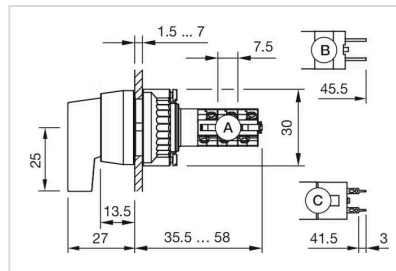

### Wiring diagrams:

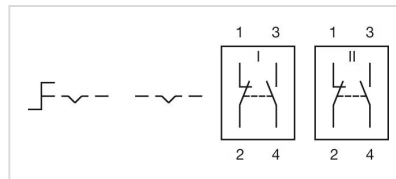

### Mounting cut-outs:

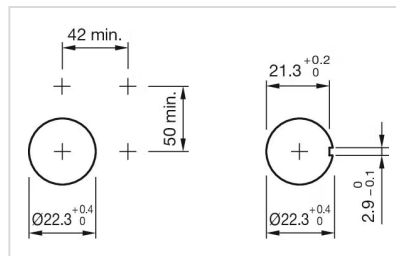

### Switching positions:

