

Pushbutton Ø  
22 mm silver contact

Distribution by  
DigiKey

**DigiKey**

82-6572.1000



<https://digikey.eao.com/p/82-6572.1000>

Your product:

---



82-6572.1000

Pushbutton Ø 22 mm silver contact

#### FRONT

**Front dimension:** Ø 25 mm

**Front form:** Round

**Front bezel material:** Aluminium

**Front bezel shape:** Flush

#### MOUNTING

**Mounting cut-out:** Ø 22 mm

**Mounting type:** Panel mounting

#### OPERATING-/INDICATION PART

**Lens colour:** Nature

**Lens material:** Aluminium

**Lens illumination:** Non illuminated

**Lens shape:** Raised

**Lens optics:** opaque

#### ELECTRICAL CHARACTERISTICS

**Switching voltage and switching current:**

according to IEC 60947-5-1 (Silver contacts)

Service categorie AC-15

Voltage

24 VAC

35 VAC

110 VAC

220 VAC

Current

1 A

1 A (M12 version)

1 A

0.5 A

Switch rating DC service categorie DC-13 (Silver contacts)

Voltage

24 VDC

35 VDC

110 VDC

220 VDC

Current

0.7 A

0.5 A (M12 version)

0.2 A

0.1 A

according to UL 508 (Silver contacts)

$\cos\phi$  0,75 ... 0,8

Voltage

120 VAC

240 VAC

24 VAC

Current

5 A

3 A

1 A

|  |  |
|--|--|
| <b>Contacts:</b>                                   | 1 C  |
| <b>Rated Operational Voltage <math>U_e</math>:</b> | 250 VAC  |
| <b>Rated insulation voltage <math>U_i</math>:</b>  | 250 V  |
| <b>Switching rating:</b>                           | 240 V  |
| <b>Electrical lifetime:</b>                        | 50 000 cycles of operation                                 |
| <b>Electric strength:</b>                          | 1500 VAC, 50 Hz 1 minute between life terminals and ground |
| <b>Pollution degree:</b>                           | 2, according to EN IEC 60947-1                             |
| <b>Thermal current <math>I_{th}</math>:</b>        | 5 A  |

## MECHANICAL CHARACTERISTIC

|                             |                                       |
|-----------------------------|---------------------------------------|
| <b>Terminal:</b>            | Screw terminal                        |
| <b>Contact material:</b>    | Silver                                |
| <b>Switching action:</b>    | Momentary                             |
| <b>Switching system:</b>    | Snap-action switching element         |
| <b>Mechanical lifetime:</b> | 1 Mil. cycles of operation            |
| <b>Operating force:</b>     | 4 N ... 7 N                           |
| <b>Operating Travel:</b>    | ca. 3 mm                              |
| <b>Tightening torque:</b>   | 0.5 ... 0.6 Nm, Screw terminal 0.1 Nm |
| <b>Weight:</b>              | 0.019 kg                              |

## AMBIENT CONDITION

**IP front protection:**

IP65, IP67

**Operating temperature:** - 30 °C ... + 70 °C

**Storage temperature:** - 40 °C ... + 80 °C

**Shock resistance:** Max. 500 m / s<sup>2</sup> as per IEC 60068-2-27

**Vibration resistance:** 10 ... 500 Hz, amplitude 1.5 mm p-p according to IEC 60068-2-6

**Climate resistance:** Damp heat, 21 days according to IEC 60512-11

## CERTIFICATE

**Approbations:** CB, CCC, C UL, UL

**Conformities:** CE, 2011 / 65 / EC (RoHS), 2014 / 35 / EU (LVD)

**REACH:** REACH compliant

**RoHS:** RoHS compliant

## OTHER

**Short Description:** Pushbutton Ø 22 mm silver contact, Momentary, 240 V, 1 C, Screw terminal, Round, Aluminium, Nature

**Wiring diagrams:**

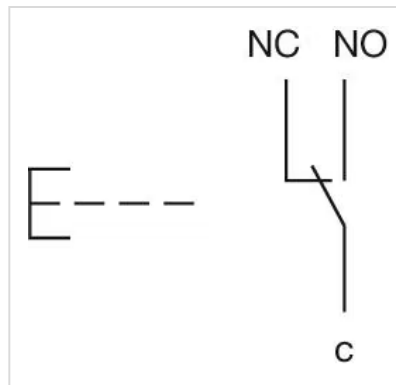

**Component layouts:**

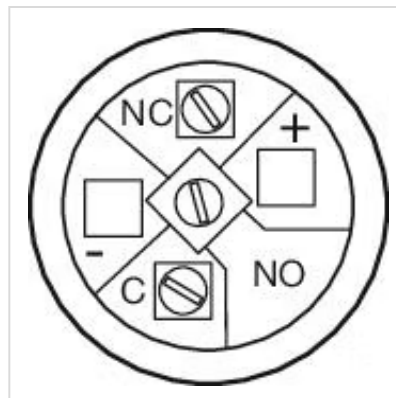

**Mounting cut-outs:**

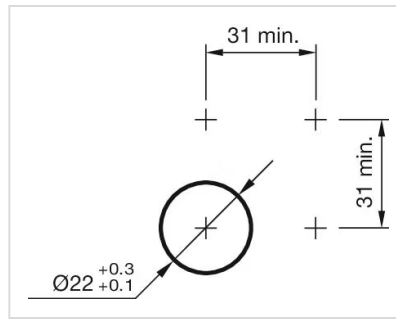

**Dimension drawings:**

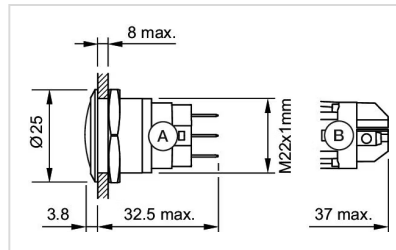

A = Solder terminal  
B = Screw terminal