

# Actuator

704.084.4

Distribution by  
DigiKey

**DigiKey**



<https://digkey.eao.com/component/704.084.4/e...>

Your product:

---



## 704.084.4 Actuator

*Loading ...*

### FRONT

|                              |         |
|------------------------------|---------|
| <b>Front dimension:</b>      | Ø 40 mm |
| <b>Front form:</b>           | Round   |
| <b>Front bezel colour:</b>   | Grey    |
| <b>Front bezel material:</b> | Plastic |

### MOUNTING

|                       |                |
|-----------------------|----------------|
| <b>Design:</b>        | Raised         |
| <b>Mounting type:</b> | Panel mounting |

### OPERATING-/INDICATION PART

|                             |               |
|-----------------------------|---------------|
| <b>Lens colour:</b>         | Yellow        |
| <b>Lens material:</b>       | Plastic       |
| <b>Lens illumination:</b>   | Illuminated   |
| <b>Lens shape:</b>          | Mushroom-head |
| <b>Lens optics:</b>         | opaque        |
| <b>Illumination colour:</b> | Yellow        |

### MECHANICAL CHARACTERISTICS

|                             |                             |
|-----------------------------|-----------------------------|
| <b>Terminal:</b>            | Screw terminal              |
| <b>Switching action:</b>    | Momentary                   |
| <b>Mechanical lifetime:</b> | ≤3 Mil. cycles of operation |
| <b>Weight:</b>              | 0.042 kg                    |

**CERTIFICATE**

**REACH:** REACH compliant

**RoHS:** RoHS compliant

**OTHER**

**Short Description:** Actuator, Ø 40 mm, Mushroom-head, Illuminated, Yellow, Plastic, opaque, Round, Grey, Plastic, Momentary, Screw terminal, Yellow

**Housing colour:** Grey

**Housing material:** Plastic

**Hints:** Max. 3 switching elements can be clipped on

**max. number of switching elements:** 3

**Wiring diagrams:**

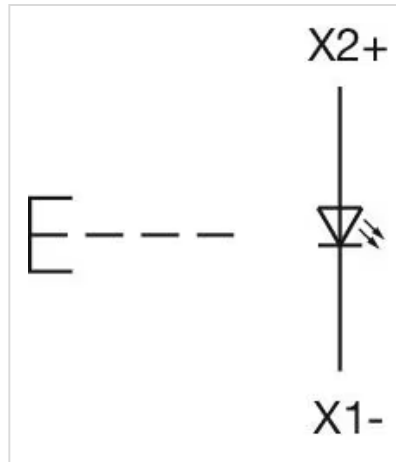

**Mounting cut-outs:**

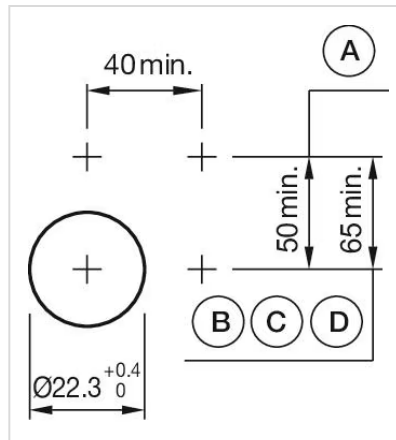

- A = Screw terminal
- B = Push-in terminal (PIT)
- C = Plug-in terminal 6.3 mm x 0.8 mm
- D = Double plug-in terminal 6.3 mm x 0.8 mm

**Dimension drawings:**



A = Screw terminal