

# Rugged Outdoor Switch

09-RS.1101.5100.M003

Distribution by  
DigiKey

**DigiKey**



<https://digikey.eao.com/p/09-RS.1101.5100.M003>

Your product:

---



## 09-RS.1101.5100.M003 Rugged Outdoor Switch

### FRONT

Front dimension:	Ø 39 mm
Front form:	Round
Front bezel colour:	Black
Front bezel material:	Plastic
Front bezel shape:	Raised

### MOUNTING

Design:	Raised
Mounting cut-out:	Ø 30 mm

### OPERATING-/INDICATION PART

Lens colour:	Light green
Lens material:	Plastic
Lens illumination:	Non illuminated
Lens shape:	Concave
Lens type:	Raised above front bezel
Symbol:	Lower
Marking symbol colour:	Black

### ELECTRICAL CHARACTERISTICS

Contacts:	1 NO
Contact Type:	Magnetic Reed Switch

<b>Operating voltage:</b>	12 - 48 V DC
<b>Power (W):</b>	10
<b>Switching rating:</b>	48 V DC @ 0,5 A
<b>Electrical lifetime:</b>	1 Mil. cycles of operation
<b>Thermal current Ith:</b>	0.5 A

## MECHANICAL CHARACTERISTICS

<b>Terminal:</b>	1.5 Series AMP Superseal 3 Pin Connector
<b>Contact material:</b>	Rhodium/Silver
<b>Switching action:</b>	Momentary
<b>Mechanical lifetime:</b>	1 Mil. cycles of operation
<b>Operating force:</b>	25 N
<b>Operating Travel:</b>	5 mm ± 0.1 mm
<b>Tightening torque:</b>	2.5 ... 3 Nm fixing nut
<b>Weight:</b>	0.04 kg

## AMBIENT CONDITION

<b>IP front protection:</b>	IP67 (ISO 20653)
<b>IP Protection:</b>	IP67 rear side (ISO 20653)
<b>Operating temperature:</b>	- 20 °C ... + 100 °C (DIN EN 60068-2-64)
<b>Storage temperature:</b>	- 20 ° C ... + 100 ° C (DIN EN 60068-2-64)
<b>Vibration resistance:</b>	Vibration TL80101 (2006-10) chapter 4.1.4 test severity level 3, Test Conditions according DIN EN 60068-2-64 test duration 2 hours per spatial axis
<b>Climate resistance:</b>	100 cycles (- 20 °C ... + 100 °C), with 25min at high temperature, 20 min at low temperature level per cycle

## CERTIFICATE

<b>Approbations:</b>	EMC (EN ISO 13766-1:2018), EMC (EN ISO 14982:2009)
<b>Conformities:</b>	CE
<b>REACH:</b>	REACH compliant
<b>RoHS:</b>	RoHS compliant

## OTHER

**Short Description:**

Rugged Outdoor Switch, Momentary, 48 V DC @ 0,5 A, 12 - 48 V DC, 1 NO, 1.5 Series AMP Superseal 3 Pin Connector, Round, Plastic, Lower, Light green

**Housing colour:**

Black

**Housing material:**

Plastic

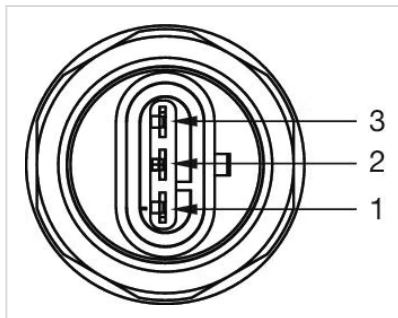
**Component layouts:**

1 = Common +  
2 = Switch Out  
3 = LED - (non illuminated - blank)

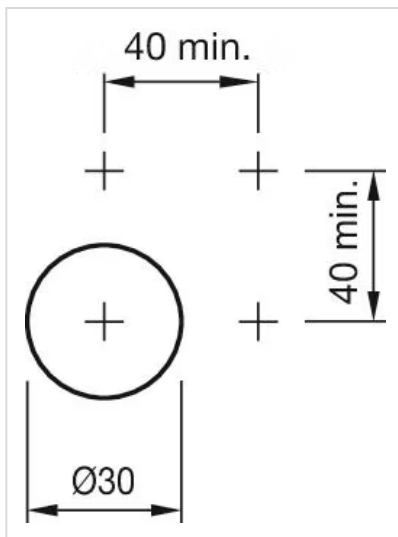
**Mounting cut-outs:****Dimension drawings:**