

# Rugged Outdoor Switch

09-RS.1101.5000.M000

Distribution by  
DigiKey

**DigiKey**



<https://digikey.eao.com/component/09-RS.1101...>

Your product:

---



## 09-RS.1101.5000.M000 Rugged Outdoor Switch

*Loading . . .*

### FRONT

|                              |         |
|------------------------------|---------|
| <b>Front dimension:</b>      | Ø 39 mm |
| <b>Front form:</b>           | Round   |
| <b>Front bezel colour:</b>   | Black   |
| <b>Front bezel material:</b> | Plastic |
| <b>Front bezel shape:</b>    | Raised  |

### MOUNTING

|                          |         |
|--------------------------|---------|
| <b>Design:</b>           | Raised  |
| <b>Mounting cut-out:</b> | Ø 30 mm |

### OPERATING-/INDICATION PART

|                           |                          |
|---------------------------|--------------------------|
| <b>Lens colour:</b>       | Light green              |
| <b>Lens material:</b>     | Plastic                  |
| <b>Lens illumination:</b> | Non illuminated          |
| <b>Lens shape:</b>        | Concave                  |
| <b>Lens type:</b>         | Raised above front bezel |
| <b>Symbol:</b>            | No Symbol                |

### ELECTRICAL CHARACTERISTICS

|                           |                      |
|---------------------------|----------------------|
| <b>Contacts:</b>          | 1 NO                 |
| <b>Contact Type:</b>      | Magnetic Reed Switch |
| <b>Operating voltage:</b> | 12 - 48 V DC         |

|  |                            |
|--|----------------------------|
| <b>Power (W):</b>                      | 10                         |
| <b>Switching rating:</b>               | 48 V DC @ 0,5 A            |
| <b>Electrical lifetime:</b>            | 1 Mil. cycles of operation |
| <b>Thermal current I<sub>th</sub>:</b> | 0.5 A                      |

## MECHANICAL CHARACTERISTICS

|                             |  |
|-----------------------------|--|
| <b>Terminal:</b>            | 1.5 Series AMP Superseal 3 Pin Connector |
| <b>Contact material:</b>    | Rhodium/Silver                           |
| <b>Switching action:</b>    | Momentary                                |
| <b>Mechanical lifetime:</b> | 1 Mil. cycles of operation               |
| <b>Operating force:</b>     | 25 N                                     |
| <b>Operating Travel:</b>    | 5 mm ± 0.1 mm                            |
| <b>Tightening torque:</b>   | 2.5 ... 3 Nm fixing nut                  |
| <b>Weight:</b>              | 0.04 kg                                  |

## AMBIENT CONDITION

|                               |   |
|-------------------------------|---|
| <b>IP front protection:</b>   | IP67 (ISO 20653)  |
| <b>IP Protection:</b>         | IP67 rear side (ISO 20653)  |
| <b>Operating temperature:</b> | - 20 °C ... + 100 °C (DIN EN 60068-2-64)  |
| <b>Storage temperature:</b>   | - 20 °C ... + 100 °C (DIN EN 60068-2-64)  |
| <b>Vibration resistance:</b>  | Vibration TL80101 (2006-10) chapter 4.1.4 test severity level 3, Test Conditions according DIN EN 60068-2-64 test duration 2 hours per spatial axis |
| <b>Climate resistance:</b>    | 100 cycles (- 20 °C ... + 100 °C), with 25min at high temperature, 20 min at low temperature level per cycle  |

## CERTIFICATE

|                      |  |
|----------------------|--|
| <b>Approbations:</b> | EMC (EN ISO 13766-1:2018), EMC (EN ISO 14982:2009) |
| <b>Conformities:</b> | CE   |
| <b>REACH:</b>        | REACH compliant                                    |
| <b>RoHS:</b>         | RoHS compliant                                     |

## OTHER

**Short Description:**

Rugged Outdoor Switch, Momentary, 48 V DC @ 0,5 A, 12 - 48 V DC, 1 NO, 1.5 Series AMP Superseal 3 Pin Connector, Round, Plastic, No Symbol, Light green

**Housing colour:** Black

**Housing material:** Plastic

**Component layouts:**

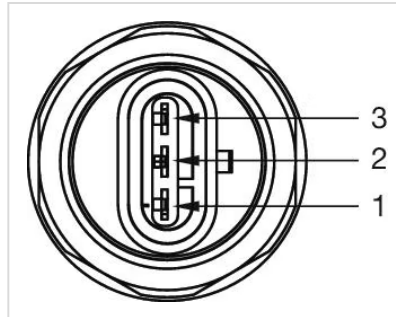

- 1 = Common +
- 2 = Switch Out
- 3 = LED - (non illuminated - blank)

**Mounting cut-outs:**

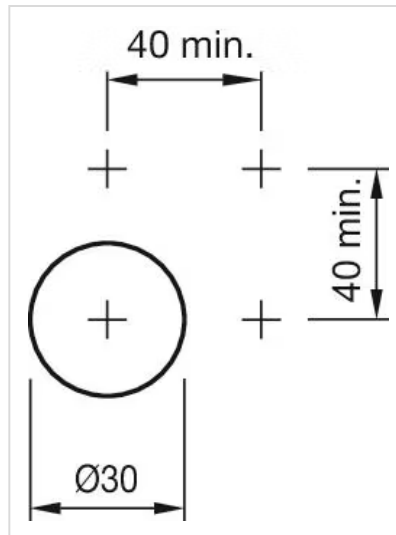

**Dimension drawings:**

